

1

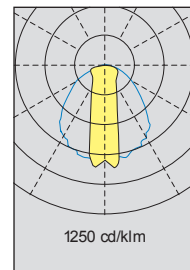

HPS wide beam

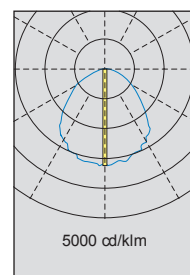

HPS narrow beam

Reflector	Part-no.	Weight kg
wide	5101 0011 ..-001	12.2
narrow	5101 0011 ..-002	12.2

Applications

decks, holds, industrial areas, etc.

Approvals

according to the rules of relevant classification societies, additional VDE and IEC

Protection class

IP 67

Housing

seamless stainless steel deep drawn, powder coated white

Diffuser

safety glass

Reflector

anodized aluminium

Lamp base

E 39

Lamps(not included)

HPS/MH lamp 1000W

Electric

120/230V ;flexible wiring, high temperature resistant

Cable entry

junction box, 1 cable gland brass, M24x1.5, with grounding insert

Mounting

adjustable bracket, stainless steel, 4 mounting holes, Ø13 mm

Options

- UL-Approval

Remark

ballast unit has to be ordered separately

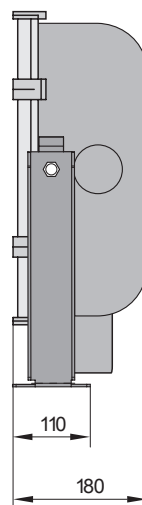
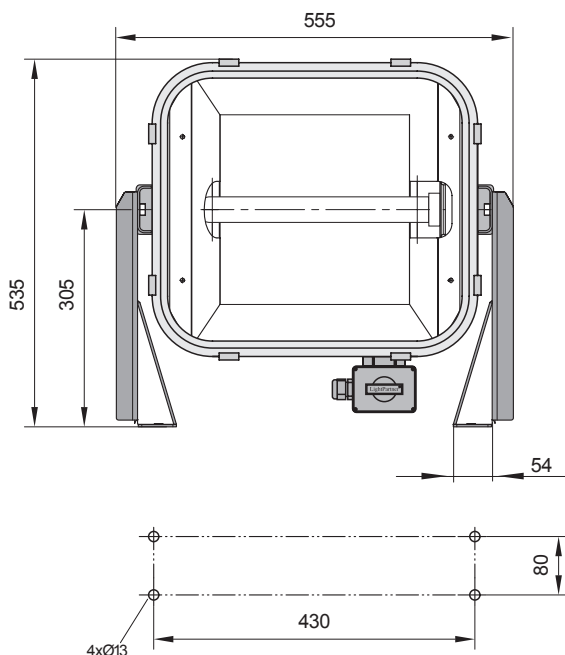

[mm]

1